

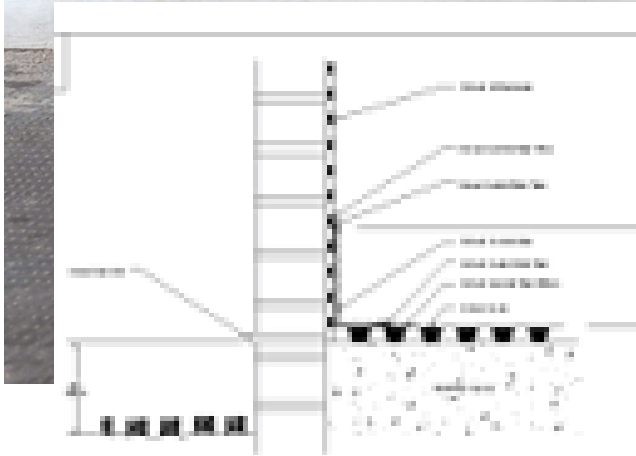

—
PRESSURE RESISTANT
WATERPROOFING
SLURRY POWDER

SWS SLURRY

2023



NO.	DESCRIPTION	QTY	UNIT
1
2
3
4
5
6
7
8
9
10

The Best Product

Cement Based
High Performance
Make Your Buildings Damp Proof

SWS Slurry

Product Description

SWS Slurry is a cement-based waterproofing coating, used for sealing and protecting structures exposed to active or passive water.

Areas of Application

Concrete and masonry substrates

- Cellars
- Active or passive waterproofing
- Basements
- Tunnels & water retaining structures
- Underground parking areas

Benefits

- Excellent Waterproof barrier to the negative and positive side
- Non-toxic
- Can be applied to damp substrates.
- Efflorescence-free
- Ease of application, simply mix and apply by brush
- Excellent Adhesion properties to sound substrates

Coverage Rates

Type of water impact	Recommended overall application rate	Total layer thickness (approx.)
Pressureless water	3 – 4 kg/m ²	1.5 – 2 mm
Water under pressure	5 kg/m ² depending on water pressure	2 – 3 mm
Appearance	Grey Powder	
Packaging	25 kg	
Storage	Keep in dry conditions at a temperature of 5°C to 35°C. Protect from frost and direct sunlight	
Pot Life	30 to 40 minutes depending on the weather conditions.	
Shelf Life	12 months	
Coverage	3 – 4kg/m ² *	
Min. Coats Required	2 Coats	
Strength	28 days 53N/M	
Tensile Strength	28 days 4.5	
Flexural Strength	28 days 11	
Adhesive Strength	28 days 3.1	

Dampen the substrate thoroughly with clean water before applying SWS Slurry. Ensure that the substrate is still damp when applying the first coat of SWS Slurry. A maximum of 2 mm (approx. 3 kg/m²*) can be applied in two coats. Please refer to relevant coverage rate. It is recommended to apply the next coat whilst the previous coat is touch dry on the surface, the previous coat must not be damaged during application of the following coat. The waiting time before applying the second coat is usually between 2 – 4 hours depending on climatic conditions such as humidity, temperature, etc. Do not apply at temperatures below +5 °C, or to a frozen substrate.

Only mix sufficient product that can be used within 40 minutes.



Re-plastering - The second has to be touch dry, for the plaster to adhere to the second coat of the SWS Slurry.

Curing of plaster

Surfaces treated with SWS Slurry cementitious products to be coated or painted should be left to cure for 4 weeks. When a plaster or b is required, it is essential to apply a rough cast of sand and cement on the SWS cementitious coat while it is still 'green'. is required, it is essential to apply a rough cast of sand and cement on the SWS cementitious coat while it is still 'green'.

On hardened surfaces apply an appropriate bonding agent before rendering, (not PVA) Coatings on top of a SWS treatment have to be alkali resistant.

Decorative coatings and paints should be water vapour permeable

Brush application

Can be used to 'prime' the surface. Ensure that all cavities in the substrate are filled and appropriate cover is achieved. It should be applied to a level surface to avoid insufficient coverage.

Trowel application

First a scratch coat is applied for maximum adhesion to the substrate, working from the bottom up. Ensure all cavities in the substrate are filled, to exclude any trapped air.

Spray application

SWS Slurry can be sprayed typically using a nozzle with a diameter of 6 mm. Apply first coat of SWS Slurry in a circular motion with spray nozzle at a 90° angle to the substrate. The material is flattened and keyed. The final layer can be left as a spray finish or for further advice refer to 'Plastering/Coating' section.

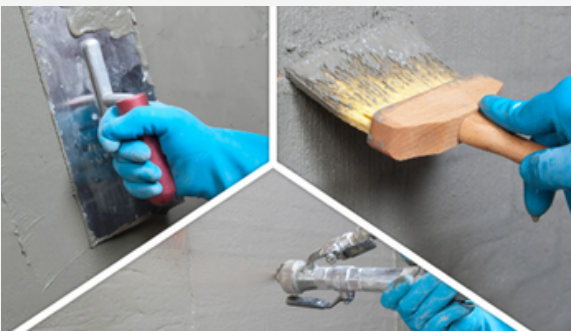

Health and Safety

Avoid spillage onto patios, paths etc; flush away any spillage immediately using concentrated detergent solution.

Do not contaminate glass or aluminium; wipe off any material immediately.

For full safety information consult material data sheet - available on request.



Other information

Information given is in good faith based on experience and usage, however all recommendations are made without warranty or guarantee, since the conditions of use are beyond our control. All goods are sold in accordance with our Conditions of Sale, copies of which are available on request. Customers are advised that products, techniques and codes of practice are under constant review and changes occur without notice; please ensure you have the latest updated information



Address: APD Industrial Park
Cnr Elsecar & Bernie streets
Kya Sand
Johannesburg
2163



011 7083603



technical@safeguardchem.co.za



www.safeguardchem.co.za



Safeguardchemicals



[safeguardchemicals](https://www.instagram.com/safeguardchemicals)



[safeguardchemicals](https://www.tiktok.com/safeguardchemicals)



[safeguardchemicalssa2888](https://www.youtube.com/safeguardchemicalssa2888)



[safeguardchemicals](https://www.linkedin.com/company/safeguardchemicals)