

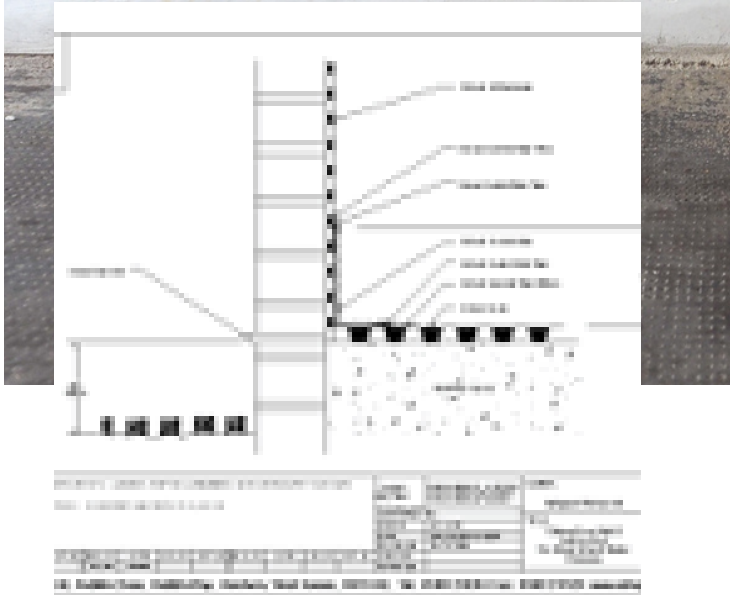

PLUGGING
SOLUTION

RAPID SETTING PLUG

2023



The Best Product

Rapid Setting Plug In Mortar
High Performance
Stop Water Flow in Seconds

RAPID SETTING PLUG

Product Description

Rapid Setting Plug is a plugging mortar supplied in powder form. It is a blend of activating chemicals, cement and high grade silica aggregates. It requires only the additions of water and hardens in a matter of seconds to seal leaks and even running water. Water flow can be stopped by mixing the Rapid Setting Plug to a malleable consistency and using as a plug.

Areas of Application

- Water retaining structures
- Basements
- Lift wells
- Inspection pits
- Tunnels and underground structures
- Joint filling
- concrete tunnel segments and pipes
- Pointing and patching repairs prior to application of water renders.
- Sinking and securing

Benefits

- Rapid setting – typically 30–60 seconds
- Easy to use – simply add water
- Chloride free – no risk to steel reinforcement
- Non-Toxic – suitable for use in potable water systems
- Repairs vertical and horizontal substrates
- Pre-mixed – giving consistent quality and results

Appearance	Grey Powder
Size(s) & Packaging	5 kg Buckets
Coverage	Per application.
Storage	Store out of direct sunlight, clear of the ground on pallets protected from rain
Pot Life	Approx.. 1 minute
Shelf Life	12 Months

Application Information

Preparation

The surface must be free of oil, dust dirt, paint curing compounds and clean free of all friable material or other contaminants that could impair adhesion. Chase out masonry around holes or cracks to be filled to a depth of at least 25mm. If possible to increase the mechanical bond, form the chase or hole so that it is wider within the wall than at the surface (an inverted “v”). Wet the area to be patched immediately prior to application. Never use on a dry substrate.

Mixing

Pour clean water into mixing container. Gradually add the Rapid Setting Plug powder to the water at the same time mixing with a small round trowel. Mix to the consistency of window putty with NO slump and for no longer than 30 seconds. Do not re-temper. When properly mixed. Rapid Setting Plug may be formed by hand into a ball. The initial set is very fast, so you must work very quickly. Water, substrate and atmospheric temperature will have an effect on setting time.

Application

Rapid Setting Plug application is often a two-man job, one mixing small batches and the other placing and holding the material with pressure until water seepage stops. Always force Rapid Setting Plug into the prepared crack or hole using maximum pressure. In the case of a crack, start at the tip and work down. When high water pressure is encountered, hold Rapid Setting Plug in your gloved hand until you feel the heat generation. At this point, force into the opening and hold in place with a trowel or by hand for a few minutes until the water stop running. Once Rapid Setting Plug has set for at least one hour, the surface may be coated with SWS Slurry or Fillet Seal as required.

Limitations

Under NO circumstances should water be increased beyond the recommended ration. Materials will have a semi-dry consistency to allow for hydration to take place with leakage water.

Equipment Care

Clean tools and equipment immediately after use with water. Hardened Rapid Setting Plug can only be removed mechanically.

Health and Safety

Avoid spillage onto patios, paths etc; flush away any spillage immediately using concentrated detergent solution.

Do not contaminate glass or aluminium; wipe off any material immediately.

For full safety information consult material data sheet – available on request.



Other information

Information given is in good faith based on experience and usage, however all recommendations are made without warranty or guarantee, since the conditions of use are beyond our control. All goods are sold in accordance with our Conditions of Sale, copies of which are available on request. Customers are advised that products, techniques and codes of practice are under constant review and changes occur without notice; please ensure you have the latest updated information



Address: APD Industrial Park
Cnr Elsecar & Bernie streets
Kya Sand
Johannesburg
2163



011 7083603



technical@safeguardchem.co.za



www.safeguardchem.co.za



[Safeguardchemicals](https://www.facebook.com/Safeguardchemicals)



[safeguardchemicals](https://www.instagram.com/safeguardchemicals)



[safeguard.chemicals](https://www.tiktok.com/@safeguard.chemicals)



[safeguardchemicalssa2888](https://www.youtube.com/channel/UCsafeguardchemicalssa2888)



[safeguard.chemicals](https://www.linkedin.com/company/safeguard.chemicals)