

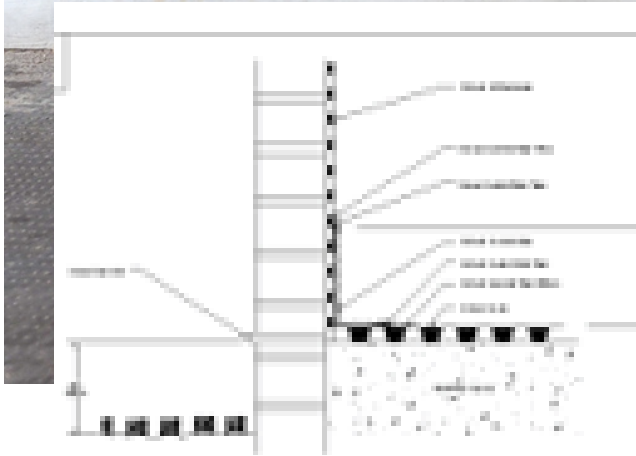

CONCENTRATED
BONDING LIQUID

BONDAID PLUS

2023



NO.	DESCRIPTION	QTY	UNIT
1	SAFEGUARD BONDING LIQUID	10	LITERS
2	SAFEGUARD WATERPROOFING MEMBRANE	5	SQ. METERS
3	SAFEGUARD DRAINAGE CHANNEL	1	METER
4	SAFEGUARD PROTECTIVE COAT	2	LITERS

The Best Product

Concentrated Cement Additive
High Performance
Make Your Buildings Dry

BONDAID PLUS



Product Description

Bondaid Plus is a styrene-butadiene rubber latex (SBR) which has been specifically designed for use with cement compositions and as a primer to improve bonding. When incorporated into cement mortar mixes it forms polymer modified systems which exhibit excellent adhesion, improved tensile and flexural strength, as well as resistance to water and water vapour. Bondaid Plus mixes are non-toxic and can be used with potable water.

Benefits

- Improves adhesion of slurry coats and sand/cement mixes
- Increases resistance to salt efflorescence
- Improves workability
- Increases flexibility of cement-based materials
- Enhances response to thermal movements

Properties

Appearance	White/milky liquid
Size(s) & Packaging	5L and 25L drums
Adhesion	Excellent to concrete, brickwork, tiles, timber, glass etc.
Storage	Store in a cool, well-ventilated area. Keep container tightly closed. Protect from frost
Shelf Life	12 months
Compressive strength	69N/mm ²
Flexure Strength	13N/mm ³
Tensile strength	6.5N/mm ²
Shrinkage during cure	0.01%

Application Information

Preparation

Prior to the application of Bondaid Plus either in the form of a primer coat, slurry coat or modified mix, the substrate surface must be fully prepared. Any exposed reinforcing steel must be clean and free from grease, oil, scale and rust. If being used to repair spalled or damaged concrete ensure the background is cut back to sound material.

Mixing

Bondaid plus may be used as a concentrated material or diluted with water at varying rates depending upon its intended use. When used with Latseal, mix 1 part Bondaid Plus with 4 parts clean water and use 6 -8 liters of the resulting mixture with every 25Kg bag of Latseal or SWS Slurry . If used in the gauging water of a sand and cement mix, the excellent plasticising properties of the Bondaid plus will mean that less water is required. Add any further water cautiously as rapid thinning can occur.



Health and Safety

Avoid spillage onto patios, paths etc; flush away any spillage immediately using concentrated detergent solution.

Do not contaminate glass or aluminium; wipe off any material immediately.

For full safety information consult material data sheet - available on request.



Other information

Information given is in good faith based on experience and usage, however all recommendations are made without warranty or guarantee, since the conditions of use are beyond our control. All goods are sold in accordance with our Conditions of Sale, copies of which are available on request. Customers are advised that products, techniques and codes of practice are under constant review and changes occur without notice; please ensure you have the latest updated information



Address: APD Industrial Park
Cnr Elsecar & Bernie streets
Kya Sand
Johannesburg
2163



011 7083603



technical@safeguardchem.co.za



www.safeguardchem.co.za



Safeguardchemicals



[safeguardchemicals](https://www.instagram.com/safeguardchemicals)



[safeguardchemicals](https://www.tiktok.com/safeguardchemicals)



[safeguardchemicalssa2888](https://www.youtube.com/safeguardchemicalssa2888)



[safeguardchemicals](https://www.linkedin.com/company/safeguardchemicals)