

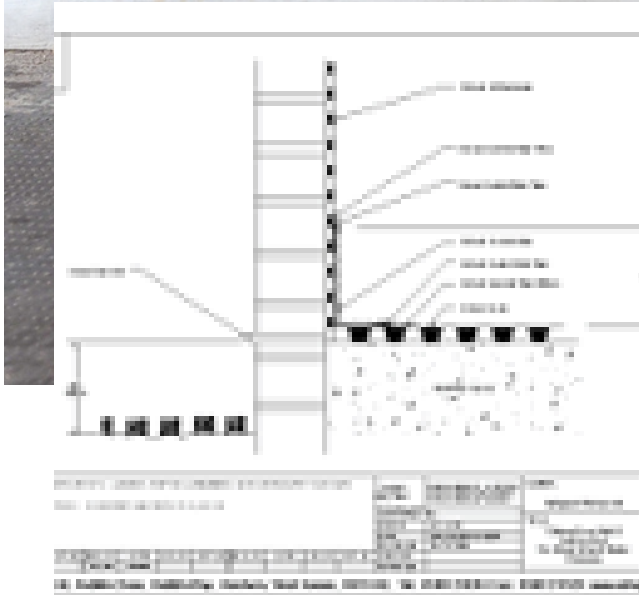

LATERAL DAMP  
TREATMENT

# LATSEAL

2023



# The Best Product

Cement Based  
High Performance  
Make Your Buildings Damp Proof

# Latseal

## Product Description

### Product Description

Latseal Slurry is a cementitious, ready-mixed surface waterproofer. The waterproofing function is achieved by a pre-mixed unique composition of plastic modified hydraulically setting cement, and selected additives. It can be used against active and passive water pressures.

The initial and final bonding capability of Latseal Slurry is excellent, making it suitable to be applied to horizontal as well as vertical surfaces. It is durable, resistant to frost and heat after setting, but also permeable to vapour.

## Areas of Application

Concrete and masonry substrates  
 Lateral Damp - wet walls  
 Active or passive waterproofing  
 Boundary walls, slabs, retaining walls, etc.  
 Ponds  
 Under tile waterproofing - showers, Balconies & Terraces

## Benefits

Excellent Waterproof barrier to the negative and positive side  
 Non-toxic  
 Can be applied to damp substrates.  
 Efflorescence-free  
 Ease of application, simply mix and apply by brush  
 Excellent Adhesion properties to sound substrates

## Coverage Rates

Type of water impact	Recommended overall application rate	Total layer thickness (approx.)
Pressureless water	3 – 4 kg/m <sup>2</sup>	1.5 – 2 mm
Water under pressure	4 – 6 kg/m <sup>2</sup> depending on water pressure	2 – 3 mm

## Preparation:

### Concrete Substrates

The substrate to be treated must be sound and even, open pored, roughened and its surface free from voids, large cracks or ridges. Any adhesion reducing substances like bitumen, oil, grease, remains of paint or laitance must be removed by suitable means, such as sandblasting, scabbling etc.

Construction joints and shrinkage cracks exceeding 0.3 mm should be routed out to a minimum depth of 20 mm. Shutter tie holes should be roughened. Water leaks must be stopped using Rapid Setting Plug. Thoroughly moisten the substrate.

It must be damp but not wet at the time of application. Any surface water on horizontal surfaces must be removed.



### Brick and Blockwork Substrates

Any remaining plaster, render or other substances that could inhibit bonding must be removed back to the substrate.

Gypsum, remains of wood or other foreign material should be removed by appropriate means. Loose mortar must be routed out and the substrate cleaned thoroughly.

### Mixing

Mix 25 kg of Latseal Slurry with 6 - 8 litres of Diluted Bondaid plus in a clean container for at least 3 minutes to a lump-free, homogeneous consistency. Use a mechanical mixer.

### Application

Latseal Slurry is applied with brush, trowel or suitable spray equipment.

Dampen the substrate thoroughly with clean water before applying Latseal Slurry. Ensure that the substrate is still damp when applying the first coat of Latseal Slurry. A maximum of 2 mm (approx. 3 kg/m<sup>2</sup>) can be applied in two coats. Please refer to relevant coverage rate. It is recommended to apply the next coat whilst the previous coat is touch dry on the surface, the previous coat must not be damaged during application of the following coat. The waiting time before applying the second coat is usually between 2 - 4 hours depending on climatic conditions such as humidity, temperature, etc. Do not apply at temperatures below +5 °C, or to a frozen substrate.

Re-plastering - The second has to be touch dry, for the plaster to adhere to the second coat of the Latseal Slurry.

#### Curing of plaster

Surfaces treated with Latseal Slurry cementitious products to be coated or painted should be left to cure for 4 weeks. When a plaster or render finish is required, it is essential to apply a rough cast of sand and cement on the Latseal cementitious coat while it is still 'green'.

On hardened surfaces apply an appropriate bonding agent before rendering, (not PVA) Coatings on top of a Latseal treatment have to be alkali resistant.

Decorative coatings and paints should be water vapour permeable

#### Brush application

Can be used to 'prime' the surface. Ensure that all cavities in the substrate are filled and appropriate cover is achieved. It should be applied to a level surface to avoid insufficient coverage.

#### Trowel application

First a scratch coat is applied for maximum adhesion to the substrate, working from the bottom up. Ensure all cavities in the substrate are filled, to exclude any trapped air.

#### Spray application

Latseal Slurry can be sprayed typically using a nozzle with a diameter of 6 mm. Apply first coat of Latseal Slurry in a circular motion with



### Properties

<b>Appearance</b>	Grey Powder
<b>Packaging</b>	25 kg
<b>Storage</b>	Keep in dry conditions at a temperature of 5°C to 35°C. Protect from frost and direct sunlight
<b>Pot life</b>	30 to 40 minutes depending on weather conditions
<b>Shelf Life</b>	12 months
<b>Total Coverage</b>	6 - 8 Square meters
<b>Min. Coats Required</b>	2 Coats

### Health and Safety

Avoid spillage onto patios, paths etc; flush away any spillage immediately using concentrated detergent solution.

Do not contaminate glass or aluminium; wipe off any material immediately.

For full safety information consult material data sheet - available on request.

### Other information

Information given is in good faith based on experience and usage, however all recommendations are made without warranty or guarantee, since the conditions of use are beyond our control. All goods are sold in accordance with our Conditions of Sale, copies of which are available on request. Customers are advised that products, techniques and codes of practice are under constant review and changes occur without notice; please ensure you have the latest updated information



Address: APD Industrial Park  
Cnr Elsecar & Bernie streets  
Kya Sand  
Johannesburg  
2163



011 7083603



[technical@safeguardchem.co.za](mailto:technical@safeguardchem.co.za)



[www.safeguardchem.co.za](http://www.safeguardchem.co.za)



[Safeguardchemicals](https://www.facebook.com/Safeguardchemicals)



[safeguardchemicals](https://www.instagram.com/safeguardchemicals)



[safeguard.chemica](https://www.tiktok.com/@safeguard.chemica)



[safeguardchemicalssa2888](https://www.youtube.com/channel/UCsafeguardchemicalssa2888)



[safeguard.chemica](https://www.linkedin.com/company/safeguard.chemica)