

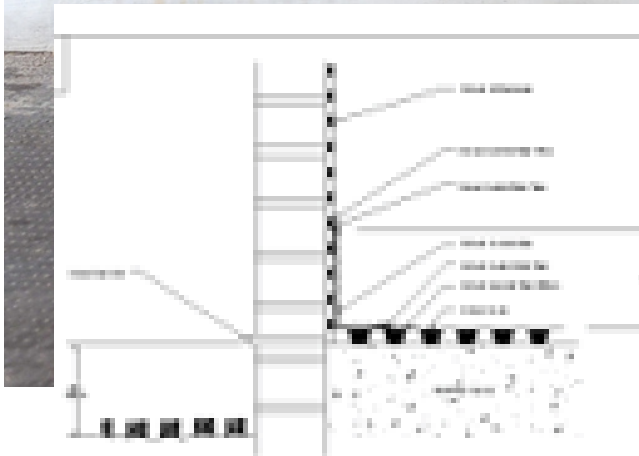

RISING DAMP
TREATMENT

DRYZONE

2023



| Product Name | Product Code | Product Description | Product Weight | Product Volume |
|---------------------|--------------|--------------------------------|----------------|----------------|
| DPC Injection Cream | DRYZONE | High Performance Damp Proofing | 10kg | 10L |
| DPC Injection Cream | DRYZONE | High Performance Damp Proofing | 5kg | 5L |
| DPC Injection Cream | DRYZONE | High Performance Damp Proofing | 2.5kg | 2.5L |

The Best Product

DPC Injection Cream
High Performance
Make Your Home Comfortable

Dryzone



Product Description

Product Description

Dryzone Damp-Proofing Cream is the industry standard for remedial rising damp treatments. It is a cream that is injected into holes drilled along a mortar bed using a special applicator gun. Once installed, the high strength formulation spreads along the mortar bed before curing to form a damp-proof course.

Dryzone's patented installation method has been optimised to ensure that it is effective on a wide range of mortar types, including the porous and low-alkalinity mortars typically found in Victorian buildings.

Appearance



Benefits

- Proven performance - approved by the BBA and numerous international test-houses
- Easy to install - no costly and complicated electric pumps required
- Usable in a wide variety of walls including brick, stone and rubble construction

[[1]] It may be necessary to use more cream per 10 m under certain conditions, e.g. where the mortar course does not form a straight line, or in rubble infill walls.

Properties

Appearance

| | | |
|--|--|-----|
| Appearance | Thick, white cream | |
| Size(s) & Packaging | 600ml foil sausage | |
| Number of 600ml sausages required per 10 m wall ^[1] | 4.5" thick wall | 1.5 |
| | 9" thick wall | 3 |
| | 13.5" thick wall | 5.1 |
| | 18" thick wall | 7 |
| Storage | Store flat and in a cool, dry, well-ventilated place. Keep container closed. | |
| Shelf Life | 18 months | |

Application Information

Preparation

Set your SDS drill to rotary hammer and select a 12 mm drill bit in excess of the required drill depth. Depending on the thickness of the wall, mark the drill bit the following distances from the tip:

| DEPTH OF DRILL HOLE | Wall Thickness | | | |
|---------------------|----------------|-------------|---------------|--------------|
| | 4½" (115 mm) | 9" (230 mm) | 13½" (345 mm) | 18" (460 mm) |
| | 95 mm | 210 mm | 325 mm | 440 mm |

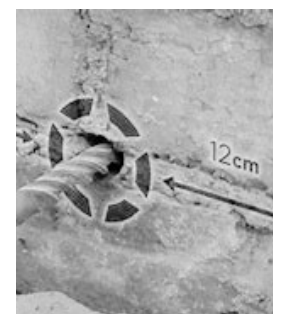

Wall thickness

| Wall Length | 4½" (115 mm) | 9" (230 mm) | 13½" (345 mm) | 18" (460 mm) |
|-------------|--------------|-------------|---------------|--------------|
| 10 m | 1.5 | 3.3 | 5.1 | 6.9 |
| 20 m | 3.0 | 6.6 | 10.2 | 13.8 |
| 30 m | 4.5 | 9.9 | 15.3 | 20.7 |



Application

When treating from outside a row of holes should be drilled into the mortar course 120 mm apart and approximately 150 mm above the ground. When treating from the inside the holes should be drilled into the lowest accessible mortar course.

Drill the holes the necessary depth ensuring you reduce your drilling pressure once you reach 40 mm short of the full hole depth. Reducing pressure ensures a cleaner hole and prevents damage to the far side of the wall.

Insert a Dryzone foil sausage into the applicator gun, ensuring the pressure piston is fully extended. Cut into the end of the cartridge so that cream will be able to flow freely. Screw the nozzle cap back onto the gun.

Fully insert the nozzle into the first drilled hole, and then inject Dryzone Damp-Proofing Cream while withdrawing the nozzle at a steady rate. Stop injecting just before removing the nozzle from the wall. Repeat for remaining holes. Minimum application temperature is 5 °C. Do not apply if freezing temperatures are expected over night.

Health and Safety

- Avoid spillage onto patios, paths etc; flush away any spillage immediately using concentrated detergent solution.
- Do not contaminate glass or aluminium; wipe off any material immediately.
- For full safety information consult material data sheet - available on request.



Other information

Information given is in good faith based on experience and usage, however all recommendations are made without warranty or guarantee, since the conditions of use are beyond our control. All goods are sold in accordance with our Conditions of Sale, copies of which are available on request. Customers are advised that products, techniques and codes of practice are under constant review and changes occur without notice; please ensure you have the latest updated information



Address: APD Industrial Park
Cnr Elsecar & Bernie streets
Kya Sand
Johannesburg
2163



011 7083603



technical@safeguardchem.co.za



www.safeguardchem.co.za



Safeguardchemicals



[safeguardchemicals](https://www.instagram.com/safeguardchemicals)



[safeguard.chemica](https://www.tiktok.com/@safeguard.chemica)



[safeguardchemicalssa2888](https://www.youtube.com/channel/UCsafeguardchemicalssa2888)



[safeguard.chemica](https://www.linkedin.com/company/safeguard.chemica)