

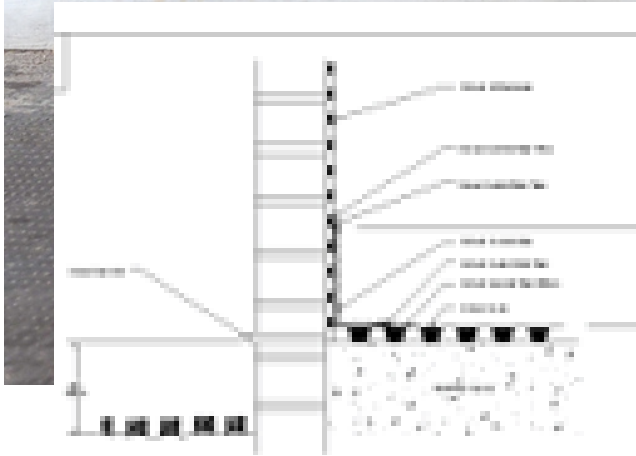

SHOWER
SEALTANT

SHOWER KIT

2023



NO.	DESCRIPTION	QTY	UNIT
1	SAFEGUARD SHOWER SEALTANT	1	KG
2	SAFEGUARD SHOWER SEALTANT	1	KG
3	SAFEGUARD SHOWER SEALTANT	1	KG
4	SAFEGUARD SHOWER SEALTANT	1	KG
5	SAFEGUARD SHOWER SEALTANT	1	KG
6	SAFEGUARD SHOWER SEALTANT	1	KG
7	SAFEGUARD SHOWER SEALTANT	1	KG
8	SAFEGUARD SHOWER SEALTANT	1	KG
9	SAFEGUARD SHOWER SEALTANT	1	KG
10	SAFEGUARD SHOWER SEALTANT	1	KG

The Best Product

Cement Based
High Performance
Make Your Shower Waterproof

Shower Kit

Product Description

Showrseal is a Flexible cement-based waterproofing slurry, specially designed to seal Showers

Area of Application

- Showers - Under tile on the floor and walls

Benefits

- Excellent Waterproof barrier to the negative and positive side
- Non-toxic
- Can be applied to damp substrates.
- Efflorescence-free
- Ease of application, simply mix and apply by brush
- Excellent Adhesion properties to sound substrates

Mixing

Mix 16 kg of Shower seal with 5 litres of Bonding Liquid in a clean container for at least 3 minutes to a lump-free, homogeneous consistency. Use a mechanical mixer.

Application Information

Preparation

The surface must be clean, properly cured and sound. All loose material must be re-moved mechanically, either with wire brush or sand/water blasting. The surface must be

Preparation:

Brick and Blockwork Substrates

Any remaining plaster, render or other substances that could inhibit bonding must be removed back to the substrate.

Gypsum, remains of wood or other foreign material should be removed by appropriate means. Loose mortar must be routed out and the substrate cleaned thoroughly.

Application Information

Preparation:

Concrete Substrates

The substrate to be treated must be sound and even, open pored, roughened and its surface free from voids, large cracks or ridges. Any adhesion reducing substances like bitumen, oil, grease, remains of paint or laitance must be removed by suitable means, such as sandblasting, scabbling etc.

Construction joints and shrinkage cracks exceeding 0.3 mm should be routed out to a minimum depth of 20 mm. Shutter tie holes should be roughened. Water leaks must be stopped using Rapid Setting Plug. Thoroughly moisten the substrate.

It must be damp but not wet at the time of application. Any surface water on horizontal surfaces must be removed.

Mixing

Mix 16 kg of Showrseal with 5 litres of Bonding Liquid in a clean container for at least 3 minutes to a lump-free, homogeneous consistency. Use a mechanical mixer.

Application

Showrseal Mixture is applied with brush, trowel or suitable spray equipment.

Packaged in 20L Bucket

16kg Showrseal
5L Bonding Liquid
200mm by 10m



Dampen the substrate thoroughly with clean water before applying Showerseal. Ensure that the substrate is still damp when applying the first coat of Showerseal. A maximum of 2 mm (approx. 3 kg/m²) can be applied in two coats with flexseal membrane on wall and floor joints. Please refer to relevant coverage rate. It is recommended to apply the next coat whilst the previous coat is touch dry on the surface, the previous coat must not be damaged during application of the following coat. The waiting time before applying the second coat is usually between 2 - 4 hours depending on climatic conditions such as humidity, temperature, etc. Do not apply at temperatures below +5 °C, or to a frozen substrate.

Re-tile according to supplier spec.



Appearance	Grey Powder + White Liquid
Packaging	16 kg + Diluted Bondaid Plus 5L
Storage	Keep in dry conditions at a temperature of 5°C to 35°C. Protect from frost and direct sunlight.
Pot Life	30 to 40 minutes depending on weather conditions
Shelf Life	12 months in unopened container
Total Coverage	5 square meters per kit
Min. Coats Required	2 Coats

Brush application

Can be used to 'prime' the surface. Ensure that all cavities in the substrate are filled and appropriate cover is achieved. It should be applied to a level surface to avoid insufficient coverage.

Trowel application

First a scratch coat is applied for maximum adhesion to the substrate, working from the bottom up. Ensure all cavities in the substrate are filled, to exclude any trapped air.

Spray application

Showrseal can be sprayed typically using a nozzle with a diameter of 6 mm. Apply first coat of Showerseal in a circular motion with spray nozzle at a 90° angle to the substrate. The material is flattened and keyed. The final layer can be left as a spray finish or for further advice refer to under tile section.

Health and Safety

Avoid spillage onto patios, paths etc; flush away any spillage immediately using concentrated detergent solution.

Do not contaminate glass or aluminium; wipe off any material immediately.

For full safety information consult material data sheet - available on request.



Other information

Information given is in good faith based on experience and usage, however all recommendations are made without warranty or guarantee, since the conditions of use are beyond our control. All goods are sold in accordance with our Conditions of Sale, copies of which are available on request. Customers are advised that products, techniques and codes of practice are under constant review and changes occur without notice; please ensure you have the latest updated information



Address: APD Industrial Park
Cnr Elsecar & Bernie streets
Kya Sand
Johannesburg
2163



011 7083603



technical@safeguardchem.co.za



www.safeguardchem.co.za



[Safeguardchemicals](https://www.facebook.com/Safeguardchemicals)



[safeguardchemicals](https://www.instagram.com/safeguardchemicals)



[safeguard.chemica](https://www.tiktok.com/safeguard.chemica)



[safeguardchemicalssa2888](https://www.youtube.com/safeguardchemicalssa2888)



[safeguard.chemica](https://www.linkedin.com/safeguard.chemica)